

MIL-P-21143/1A
 10 April 1987
 SUPERSEDING
 MIL-P-21143/1
 20 June 1984

MILITARY SPECIFICATION SHEET

PIN, STRAIGHT, HEADLESS, (DOWEL) (.0002 OVER SIZE), CRES 303

This specification is approved for use by all Departments and Agencies of the Department of Defense.

The requirements for acquiring the pins described herein shall consist of this specification and the latest issue of MIL-P-21143.

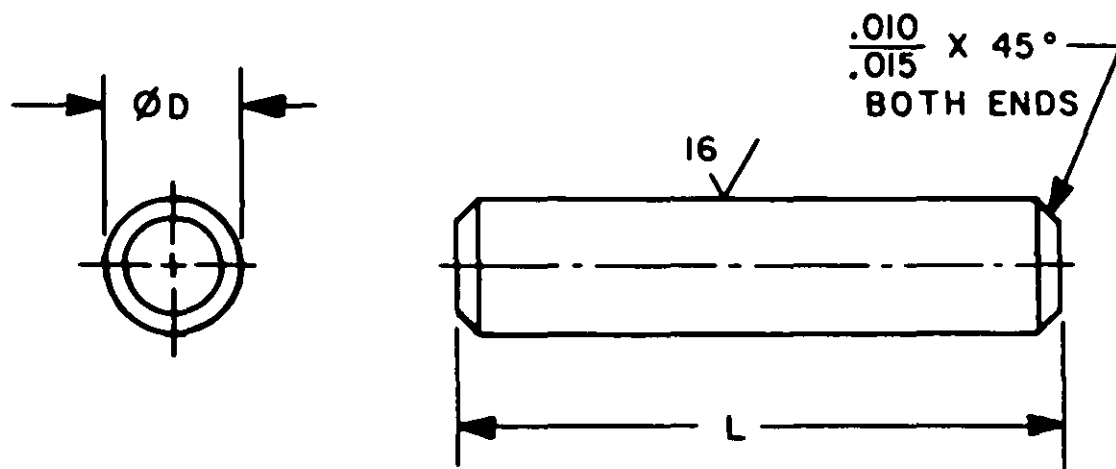

NOTES:

1. All dimensions are in inches.

FIGURE 1. PIN, STRAIGHT, HEADLESS (DOWEL) (.0002 OVER SIZE), CRES 303

(A) DENOTES CHANGES

MIL-P-21143/1A

REQUIREMENTS:

1. Material. CRES, Type 303 (UNS S30300) as specified in ASTM A582.
2. Cleaning, descaling and passivation. The pins shall be cleaned, descaled and passivated in accordance with ASTM A380.
3. Part number. The part number consists of the letter "M", the basic number of this specification sheet and a dash number taken from Table I.

Example: M21143/1-6

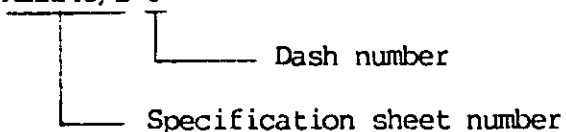

M21143/1-6 indicates - Pin, straight, headless (dowel) (.0002 over size), CRES, Type 303 (UNS S30300) length .500, diameter .0625

MIL-P-21143/1A

TABLE I. Dash numbers and dimensions.

L LENGTH ±.010	$\varnothing D$ +.0002 -.0000						
	.0625	.0937	.1250	.1875	.2500	.3125	.3750
	DASH NUMBERS						
.125	1	16	31	46	61	76	91
.188	2	17	32	47	62	77	92
.250	3	18	33	48	63	78	93
.312	4	19	34	49	64	79	94
.375	5	20	35	50	65	80	95
.500	6	21	36	51	66	81	96
.625	7	22	37	52	67	82	97
.750	8	23	38	53	68	83	98
.875	9	24	39	54	69	84	99
1.000	10	25	40	55	70	85	100
(A) 1.125	—	—	—	56	71	86	101
1.250	—	—	—	57	72	87	102
1.375	—	—	—	—	—	88	103
1.500	—	—	—	—	—	89	104
(A) 1.750	—	—	—	—	—	—	—
2.000	—	—	—	—	—	90	—

MIL-P-21143/1A

Custodians:

Army-AR
Navy-OS
Air Force-99

Preparing activity:

Army-AR

Reviewing activities:

Army-ER, MI
Air Force-82
DLA-IS

Agent:

DLA-IS

User activities:

Army- CE, GL
Navy- MC, YD

(Project 5315-0418)