

INCH-POUND

MIL-DTL-8783/1A

30 July 2008

SUPERSEDING

MIL-DTL-8783/1

6 July 1998

## DETAIL SPECIFICATION SHEET

## CLAMP, HOSE, FLAT BAND 500 °F

This specification is approved for use by all Departments and Agencies of the Department of Defense.

The requirements for acquiring the product described herein shall consist of this specification sheet and MIL-DTL-8783.

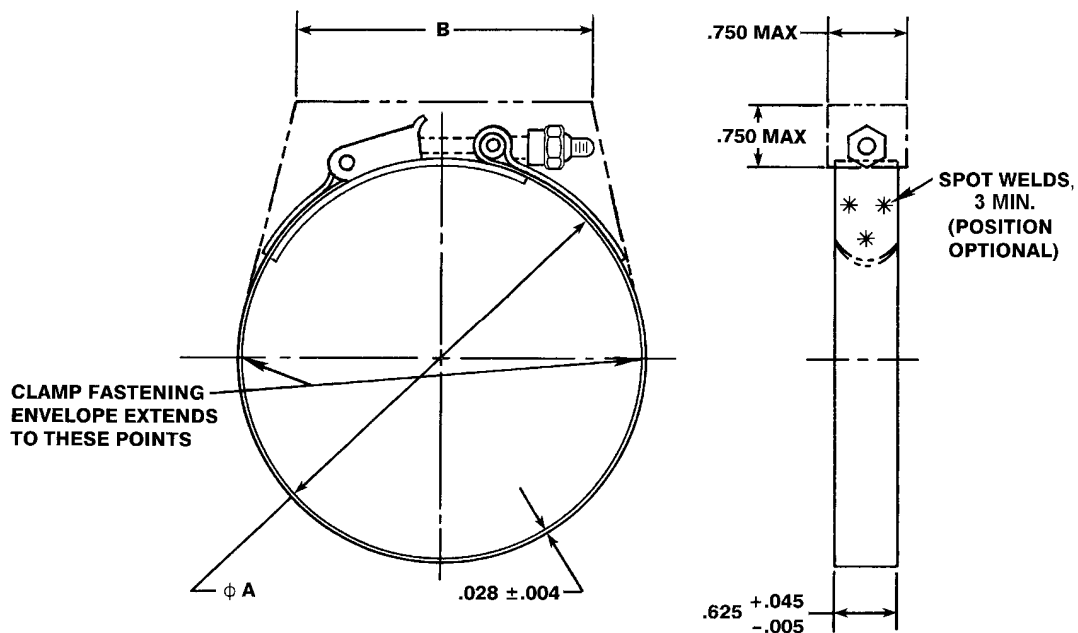

| Inches | mm    |
|--------|-------|
| .004   | 0.10  |
| .005   | 0.13  |
| .028   | 0.71  |
| .045   | 1.14  |
| .625   | 15.88 |
| .750   | 19.05 |

## NOTES:

1. Dimensions in inches, metric equivalents are given for information only.
2. The illustration is for identification purposes only and is not intended to restrict designs and shapes of fastening devices, which conform to the requirements and are within the envelope dimensions.

FIGURE 1. Hose clamp.

## MIL-DTL-8783/1A

TABLE I. Dimensions for parts that are active for new design (new weapon systems only). 1/ 2/

| T-bolt latch | Quick release latch | A<br>Inside<br>diametral range |       |                   |       | B<br>Maximum   |                          | Adjustment<br>range<br>T-bolt | Wt/lbs<br>max<br>quick<br>release | Wt/lbs<br>max<br>T-bolt |      |      |      |      |      |      |      |                |                 |                 |      |      |      |      |      |
|--------------|---------------------|--------------------------------|-------|-------------------|-------|----------------|--------------------------|-------------------------------|-----------------------------------|-------------------------|------|------|------|------|------|------|------|----------------|-----------------|-----------------|------|------|------|------|------|
|              |                     | Extended<br>min                |       | Compressed<br>max |       | T-bolt<br>type | Quick<br>release<br>type |                               |                                   |                         |      |      |      |      |      |      |      |                |                 |                 |      |      |      |      |      |
|              |                     | Inches                         | mm    | Inches            | mm    |                |                          |                               |                                   |                         |      |      |      |      |      |      |      |                |                 |                 |      |      |      |      |      |
| MS21920-20   | MS21920-20R         | 2.50                           | 63.5  | 2.25              | 57.2  | 3.0<br>(76.2)  | .25<br>(6.35)            | .139                          | .095                              |                         |      |      |      |      |      |      |      |                |                 |                 |      |      |      |      |      |
| MS21920-22   | MS21920-22R         | 2.75                           | 69.9  | 2.50              | 63.5  |                |                          |                               |                                   | .143                    | .099 |      |      |      |      |      |      |                |                 |                 |      |      |      |      |      |
| MS21920-24   | MS21920-24R         | 3.00                           | 76.2  | 2.75              | 69.9  |                |                          |                               |                                   |                         |      | .146 | .102 |      |      |      |      |                |                 |                 |      |      |      |      |      |
| MS21920-26   | MS21920-26R         | 3.25                           | 82.6  | 3.00              | 76.2  |                |                          |                               |                                   |                         |      |      |      | .150 | .106 |      |      |                |                 |                 |      |      |      |      |      |
| MS21920-28   | MS21920-28R         | 3.50                           | 88.9  | 3.25              | 82.6  |                |                          |                               |                                   |                         |      |      |      |      |      | .153 | .109 |                |                 |                 |      |      |      |      |      |
| MS21920-30   | MS21920-30R         | 3.75                           | 95.3  | 3.50              | 88.9  |                |                          |                               |                                   |                         |      |      |      |      |      |      |      | .157           | .113            |                 |      |      |      |      |      |
| MS21920-33   | MS21920-33R         | 4.12                           | 104.6 | 3.75              | 95.3  |                |                          |                               |                                   |                         |      |      |      |      |      |      |      |                |                 | .164            | .120 |      |      |      |      |
| MS21920-35   | MS21920-35R         | 4.38                           | 111.3 | 4.00              | 101.6 |                |                          |                               |                                   |                         |      |      |      |      |      |      |      |                |                 |                 |      | .167 | .123 |      |      |
| MS21920-37   | MS21920-37R         | 4.62                           | 117.3 | 4.25              | 108.0 |                |                          |                               |                                   |                         |      |      |      |      |      |      |      |                |                 |                 |      |      |      | .171 | .127 |
| MS21920-39   | MS21920-39R         | 4.88                           | 124.0 | 4.50              | 114.3 |                |                          |                               |                                   |                         |      |      |      |      |      |      |      |                |                 |                 |      |      |      |      |      |
| MS21920-41   | MS21920-41R         | 5.12                           | 130.0 | 4.75              | 120.7 |                | .178                     | .134                          |                                   |                         |      |      |      |      |      |      |      |                |                 |                 |      |      |      |      |      |
| MS21920-43   | MS21920-43R         | 5.38                           | 136.7 | 5.00              | 127.0 |                |                          |                               | .181                              | .137                    |      |      |      |      |      |      |      |                |                 |                 |      |      |      |      |      |
| MS21920-45   | MS21920-45R         | 5.62                           | 142.7 | 5.25              | 133.4 |                |                          |                               |                                   |                         | .185 | .141 |      |      |      |      |      |                |                 |                 |      |      |      |      |      |
| MS21920-47   | MS21920-47R         | 5.88                           | 149.4 | 5.50              | 139.7 |                |                          |                               |                                   |                         |      |      | .188 | .144 |      |      |      |                |                 |                 |      |      |      |      |      |
| MS21920-49   | MS21920-49R         | 6.12                           | 155.4 | 5.75              | 146.1 |                |                          |                               |                                   |                         |      |      |      |      | .192 | .148 |      |                |                 |                 |      |      |      |      |      |
| MS21920-51   | MS21920-51R         | 6.38                           | 162.1 | 6.00              | 153.4 |                |                          |                               |                                   |                         |      |      |      |      |      |      | .195 | .151           |                 |                 |      |      |      |      |      |
| MS21920-53   | MS21920-53R         | 6.62                           | 168.1 | 6.25              | 158.8 |                |                          |                               |                                   |                         |      |      |      |      |      |      |      |                | .199            | .155            |      |      |      |      |      |
| MS21920-55   | MS21920-55R         | 6.88                           | 174.8 | 6.50              | 165.1 |                |                          |                               |                                   |                         |      |      |      |      |      |      |      |                |                 |                 | .202 | .158 |      |      |      |
| MS21920-57   | MS21920-57R         | 7.12                           | 180.8 | 6.75              | 171.5 |                |                          |                               |                                   |                         |      |      |      |      |      |      |      |                |                 |                 |      |      | .205 | .161 |      |
| MS21920-59   | MS21920-59R         | 7.38                           | 187.5 | 7.00              | 177.8 |                |                          |                               |                                   |                         |      |      |      |      |      |      |      |                |                 |                 |      |      |      |      | .209 |
| MS21920-61   | MS21920-61R         | 7.62                           | 193.5 | 7.25              | 184.2 | .212           | .168                     |                               |                                   |                         |      |      |      |      |      |      |      |                |                 |                 |      |      |      |      |      |
| MS21920-66   | MS21920-66R         | 8.25                           | 209.5 | 7.62              | 193.5 |                |                          | .227                          | .188                              |                         |      |      |      |      |      |      |      |                |                 |                 |      |      |      |      |      |
| MS21920-70   | MS21920-70R         | 8.75                           | 222.3 | 8.12              | 206.2 |                |                          |                               |                                   | .234                    | .190 |      |      |      |      |      |      |                |                 |                 |      |      |      |      |      |
| MS21920-74   | MS21920-74R         | 9.25                           | 235.0 | 8.62              | 218.9 |                |                          |                               |                                   |                         |      | .241 | .197 |      |      |      |      |                |                 |                 |      |      |      |      |      |
| MS21920-78   | MS21920-78R         | 9.75                           | 246.4 | 9.12              | 231.6 |                |                          |                               |                                   |                         |      |      |      | .248 | .204 |      |      |                |                 |                 |      |      |      |      |      |
| MS21920-80   | MS21920-80R         | 10.00                          | 254.0 | 9.38              | 238.3 |                |                          |                               |                                   |                         |      |      |      |      |      | .251 | .207 |                |                 |                 |      |      |      |      |      |
|              |                     |                                |       |                   |       |                |                          |                               |                                   |                         |      |      |      |      |      |      |      | 3.8<br>(96.52) | 4.2<br>(106.68) | .62<br>(157.48) |      |      |      |      |      |
|              |                     |                                |       |                   |       |                |                          |                               |                                   |                         |      |      |      |      |      |      |      |                |                 |                 |      |      |      |      |      |
|              |                     |                                |       |                   |       |                |                          |                               |                                   |                         |      |      |      |      |      |      |      |                |                 |                 |      |      |      |      |      |
|              |                     |                                |       |                   |       |                |                          |                               |                                   |                         |      |      |      |      |      |      |      |                |                 |                 |      |      |      |      |      |
|              |                     |                                |       |                   |       |                |                          |                               |                                   |                         |      |      |      |      |      |      |      |                |                 |                 |      |      |      |      |      |
|              |                     |                                |       |                   |       |                |                          |                               |                                   |                         |      |      |      |      |      |      |      |                |                 |                 |      |      |      |      |      |
|              |                     |                                |       |                   |       |                |                          |                               |                                   |                         |      |      |      |      |      |      |      |                |                 |                 |      |      |      |      |      |
|              |                     |                                |       |                   |       |                |                          |                               |                                   |                         |      |      |      |      |      |      |      |                |                 |                 |      |      |      |      |      |
|              |                     |                                |       |                   |       |                |                          |                               |                                   |                         |      |      |      |      |      |      |      |                |                 |                 |      |      |      |      |      |
|              |                     |                                |       |                   |       |                |                          |                               |                                   |                         |      |      |      |      |      |      |      |                |                 |                 |      |      |      |      |      |

1/ Dimensions are in inches.

2/ Metric equivalents are given for information only.

## MIL-DTL-8783/1A

TABLE II. Dimensions, for parts that are Inactive for new design (replacement parts only). 1/ 2/

| T-bolt latch | Quick release latch | A<br>Inside<br>diametral range |       |                   |       | B<br>Maximum   |                           | Adjustment<br>range<br>ref | Weight<br>Pounds<br>max |
|--------------|---------------------|--------------------------------|-------|-------------------|-------|----------------|---------------------------|----------------------------|-------------------------|
|              |                     | Extended<br>min                |       | Compressed<br>max |       | T-bolt<br>type | Quick-<br>release<br>type |                            |                         |
|              |                     | Inches                         | mm    | Inches            | mm    |                |                           |                            |                         |
| MS21920-21   | MS21920-21R         | 2.62                           | 66.5  | 2.38              | 60.5  | 3.0<br>(76.2)  | 3.4<br>(86.36)            | .25<br>(6.35)              | .143                    |
| MS21920-23   | MS21920-23R         | 2.88                           | 73.2  | 2.62              | 66.5  |                |                           |                            | .146                    |
| MS21920-25   | MS21920-25R         | 3.12                           | 79.2  | 2.88              | 73.2  |                |                           |                            | .150                    |
| MS21920-27   | MS21920-27R         | 3.38                           | 85.9  | 3.12              | 79.2  |                |                           |                            | .153                    |
| MS21920-29   | MS21920-29R         | 3.62                           | 91.9  | 3.38              | 85.9  |                |                           |                            | .157                    |
| MS21920-32   | MS21920-32R         | 4.00                           | 101.6 | 3.62              | 91.9  |                |                           | .164                       |                         |
| MS21920-34   | MS21920-34R         | 4.25                           | 108.0 | 3.88              | 98.6  |                |                           | .167                       |                         |
| MS21920-36   | MS21920-36R         | 4.50                           | 114.3 | 4.12              | 104.6 |                |                           | .171                       |                         |
| MS21920-38   | MS21920-38R         | 4.75                           | 120.7 | 4.38              | 111.3 |                |                           | .174                       |                         |
| MS21920-40   | MS21920-40R         | 5.00                           | 127.0 | 4.62              | 117.3 |                |                           | .178                       |                         |
| MS21920-42   | MS21920-42R         | 5.25                           | 133.4 | 4.88              | 124.0 |                |                           | .181                       |                         |
| MS21920-44   | MS21920-44R         | 5.50                           | 139.7 | 5.12              | 130.0 |                |                           | .185                       |                         |
| MS21920-46   | MS21920-46R         | 5.75                           | 146.1 | 5.38              | 136.7 |                |                           | .188                       |                         |
| MS21920-48   | MS21920-48R         | 6.00                           | 152.4 | 5.62              | 142.7 |                |                           | .192                       |                         |
| MS21920-50   | MS21920-50R         | 6.25                           | 158.8 | 5.88              | 149.4 |                |                           | .195                       |                         |
| MS21920-52   | MS21920-52R         | 6.50                           | 165.1 | 6.12              | 155.4 |                |                           | .199                       |                         |
| MS21920-54   | MS21920-54R         | 6.75                           | 171.5 | 6.38              | 162.1 |                |                           | .202                       |                         |
| MS21920-56   | MS21920-56R         | 7.00                           | 177.8 | 6.62              | 168.1 |                |                           | .205                       |                         |
| MS21920-58   | MS21920-58R         | 7.25                           | 184.2 | 6.88              | 174.8 |                |                           | .209                       |                         |
| MS21920-60   | MS21920-60R         | 7.50                           | 190.5 | 7.12              | 180.8 |                |                           | .212                       |                         |
| MS21920-64   | MS21920-64R         | 8.00                           | 203.2 | 7.38              | 187.5 | .227           |                           |                            |                         |
| MS21920-68   | MS21920-68R         | 8.50                           | 215.9 | 7.88              | 200.2 | .62<br>(15.74) | .234                      |                            |                         |
| MS21920-72   | MS21920-72R         | 9.00                           | 228.6 | 8.38              | 212.9 |                | .241                      |                            |                         |
| MS21920-76   | MS21920-76R         | 9.50                           | 241.3 | 8.88              | 225.6 |                | .248                      |                            |                         |

1/ Dimensions are in inches.

2/ Metric equivalents are given for information only.

## REQUIREMENTS:

The hose clamp shall be specified on figure 1 and in tables I and II.

Material: See acquisition specification.

Finish: See acquisition specification.

Dimension B applies when the clamp is in the tightened condition at the maximum and minimum positions of its diametral range.

The T-bolt head/shank fillet radius shall be 0.030 inch minimum.

Remove all burrs and sharp edges.

Changes from previous issue. Marginal notations are not used in this revision to identify changes with respect to the previous issue due to the extent of the changes.

Referenced document. This document references MIL-DTL-8783.

MIL-DTL-8783/1A

CONCLUDING MATERIAL

Custodians:

Army - AR  
Navy - AS  
Air Force - 99  
DLA - CC

Preparing activity:

DLA - CC

(Project 4730-2008-093)

Review activities:

Army - AT, AV, MI  
Navy - CG, MC, SA, SH  
Air Force - 71

NOTE: The activities listed above were interested in this document as of the date of this document. Since organizations and responsibilities can change, you should verify the currency of the information above using the ASSIST Online database at <http://assist.daps.dla.mil>