

INCH-POUND

MIL-DTL-12133/2C
19 October 2015
SUPERSEDING
MIL-W-12133/2B
17 June 1994

DETAIL SPECIFICATION SHEET

WASHER, SPRING TENSION, BELLEVILLE SPRING,
CORROSION RESISTANT STEEL

This specification is approved for use by all Departments and Agencies of the Department of Defense.

The requirements for acquiring the product described herein shall consist of this specification sheet and procurement specification MIL-DTL-12133.

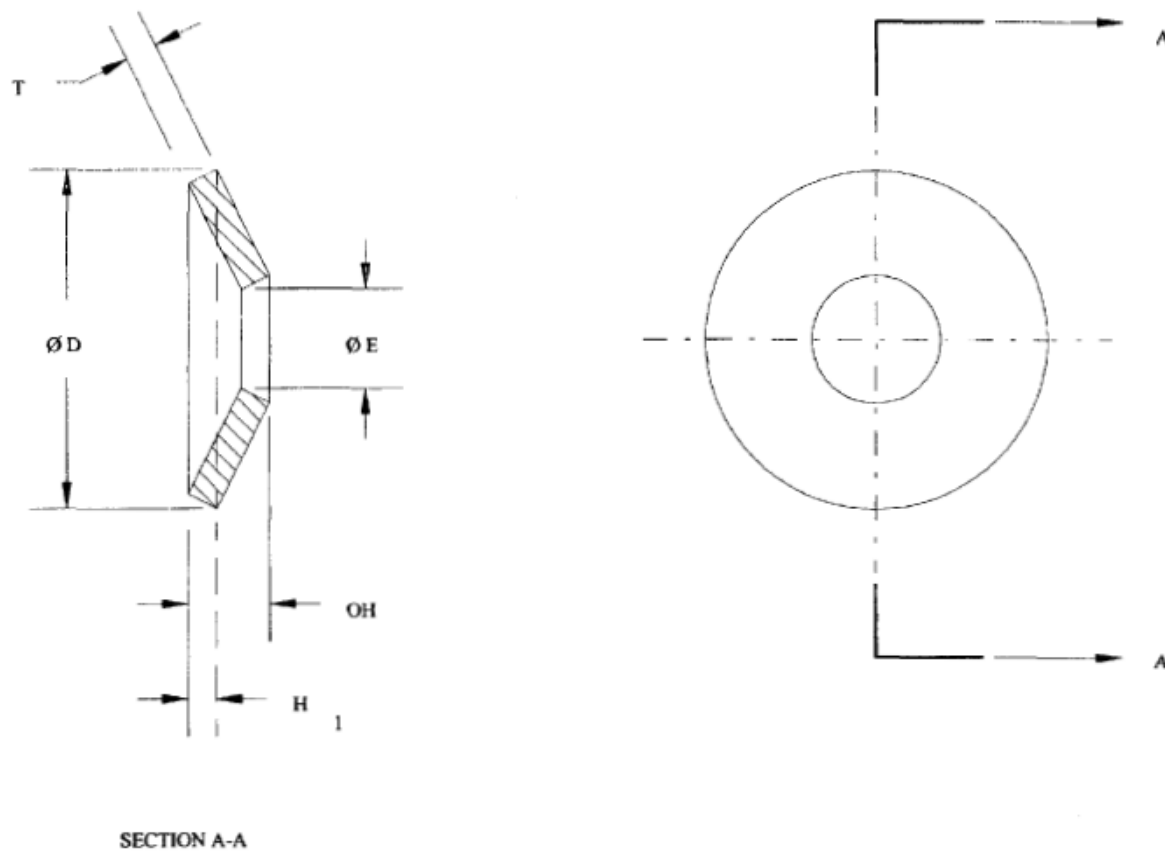

FIGURE 1. WASHER, SPRING TENSION, BELLEVILLE SPRING, CORROSION RESISTANT STEEL.

MIL-DTL-12133/2C

TABLE I. DASH NUMBERS AND DIMENSIONS.

| Dash No. | Ø D | | Ø E | | T Thickness | | OH Free Height | H1 Test Deflection (Ref) | Lbs Load at Test Deflection (Lbs) | Load at Flat (Lbs)Ref Height (Nom) | Bolt Diameter (Ref) |
|----------|-------|--------------|-------|--------------|----------------|-------|----------------------|-----------------------------------|--|--|---------------------------|
| | OD | Tol +.000 | ID | Tol -.000 | Nom | Tol | Nom | | | | |
| 093 | .187 | -.020 | .093 | +.020 | .010 | ±.001 | .015 | .002 | 15-18 | 27 | .094 |
| 125 | .250 | -.020 | .125 | +.020 | .013 | ±.001 | .020 | .003 | 22-27 | 45 | .125 |
| 156 | .312 | -.020 | .156 | +.020 | .017 | ±.001 | .025 | .004 | 34-49 | 77 | .156 |
| 190 | .375 | -.020 | .190 | +.020 | .020 | ±.001 | .030 | .005 | 50-72 | 110 | .188 |
| 200 | .375 | -.020 | .190 | +.020 | .015 | ±.001 | .027 | .006 | 33-45 | 55 | .188 |
| 255 | .500 | -.030 | .255 | +.030 | .025 | ±.001 | .038 | .007 | 80-109 | 157 | .250 |
| 400 | .625 | -.030 | .317 | +.030 | .022 | ±.002 | .042 | .010 | 56-85 | 104 | .313 |
| 317 | .625 | -.030 | .317 | +.030 | .032 | ±.002 | .048 | .008 | 123-175 | 259 | .313 |
| 380 | .750 | -.035 | .380 | +.035 | .040 | ±.002 | .059 | .010 | 210-281 | 418 | .375 |
| 505 | 1.000 | -.035 | .505 | +.035 | .050 | ±.002 | .075 | .013 | 308-428 | 596 | .500 |
| 567 | 1.125 | -.035 | .567 | +.035 | .056 | ±.002 | .084 | .014 | 374-499 | 745 | .563 |
| 630 | 1.250 | -.040 | .630 | +.040 | .062 | ±.002 | .092 | .015 | 440-582 | 876 | .625 |
| 755 | 1.500 | -.040 | .755 | +.040 | .045 | ±.002 | .093 | .024 | 239-301 | 367 | .750 |
| 100 | 2.000 | -.040 | 1.000 | +.040 | .065 | ±.002 | .130 | .032 | 547-651 | 842 | 1.000 |
| 900 | 2.500 | -.040 | 1.250 | +.040 | .125 | ±.005 | .180 | .030 | 1683-2161 | 3268 | 1.250 |

REQUIREMENTS:

1. Material. Corrosion resistant steel (CRES) (see MIL-DTL-12133).
2. Cleaning, descaling and passivation. Corrosion resistant steel washers shall be cleaned, descaled and passivated (see MIL-DTL-12133).
3. Part number: The part number consists of the letter "M", the basic number of this specification sheet, followed by a dash number taken from Table I.

Example: M12133/2 - 093

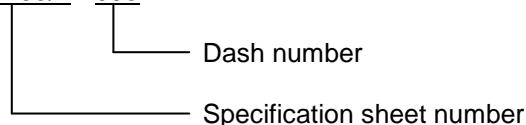

M12133/2-093 Indicates – Washer, Spring Tension, Belleville Spring, Corrosion Resistant Steel, .187 OD, .093 ID, .010 thick, .015 free height.

MIL-DTL-12133/2C

NOTES:

1. All dimensions are in inches. See Table I herein for tabulated data.
2. CHANGES FROM PREVIOUS ISSUE. Marginal notations are not used in this revision to identify changes with respect to the previous issue due to the extent of the changes.

MILITARY INTEREST

Custodians:

Army - AR
Navy - OS
Air Force - 99

Preparing activity:

DLA - IS

(Project 5310-2015-007)

Review activities:

Army – AT, CR, CR4, MI
Navy – AS, MC, YD
Air Force - 71

NOTE: The activities listed above were interested in this document as of the date of this document. Since organizations and responsibilities can change, you should verify the currency of the information above using the ASSIST Online database at <https://assist.dla.mil>.