

QQ-W-428/2
9 April 1991

FEDERAL SPECIFICATION SHEET

WIRE, STEEL, HIGH CARBON, ROUND, TYPE III

This specification is approved by the Commissioner, Federal Supply Service, General Services Administration, for the use of all Federal agencies.

The complete requirements for procuring the wire described herein shall consist of this document and the latest issue of QQ-W-428/GEN.

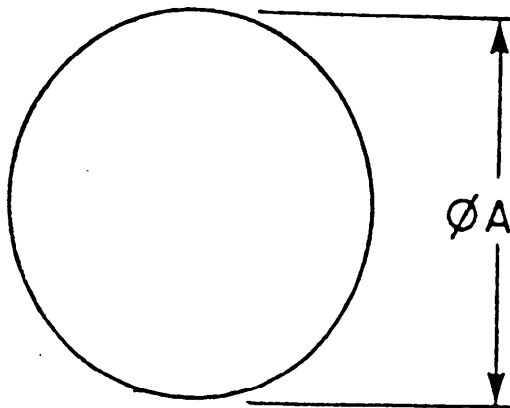

NOTES:

1. All dimensions are in inches.

FIGURE 1. WIRE, STEEL, HIGH CARBON, ROUND, TYPE III

AMSC N/A

FSC 9505

DISTRIBUTION STATEMENT A. Approved for public release; distribution is unlimited.

QQ-W-428/2

Requirements:

1. Material. Wire, steel, high carbon, soft spring wire and classes as specified in Table I.
2. Marking. Products shall be marked in accordance with MIL-STD-163 with the exception that a part number from this federal specification sheet shall be included as part of the identification marking.
3. Part number. The part number consists of the basic number of this specification sheet, a class code taken from Table I and a dash number taken from Table II.

EXAMPLE: QQW428/2 B 001

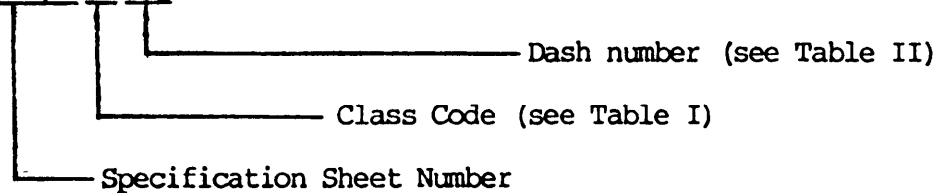

QQW428/2B001 indicates - Wire, Steel, High Carbon: OD 0.0317 inches: length 373 feet; Class Code (307-347 K.S.I. tensile strength)

Table I Classes and Codes

Class	Codes	
1	A	Spheroidize-annealed as specified in procurement specification
2	B	

TABLE II DASH NUMBERS AND DIMENSIONS

DASH NUMBER	A (IN.)	LENGTH (FT) APPROX	FT/LB APPROX	CL = COIL SL = SPOOL FT = FEET	CLASS
-001	0.0317	373	373.1	1 LB/SL	B
-003	0.0348	309	309.6	1 LB/SL	B
-005	0.0410	5575	223	25 LB/CL	B
-007	0.0625	2399.500	95.98	25 LB/CL	B
-009	0.0915	1119.500	44.78	25 LB/CL	B
-011	0.120	645.500	25.82	25 LB/CL	B
-013	0.135	103.000	20.57	5 LB/CL	B
-015	0.162	357.250	14.29	25 LB/CL	B
-017	0.313	16 MIN 20 MAX	4.2 MIN 5.2 MAX	FT	B

Military Interests:

Preparing Activity:

Army - MR

Military Coordinating Activity:

(Project 9505-0231)

Navy - OS

Review Activities:

Army - AR

Navy - AS

Air Force - 99

DLA - IS

User Activity:

Army - AV