

[INCH-POUND]
A-A-2921B
9 December 2013
SUPERSEDING
A-A-2921A
17 December 2002

COMMERCIAL ITEM DESCRIPTION

COUPLING ASSEMBLIES AND MENDERS, HOSE

The General Services Administration has authorized the use of this commercial item description by all federal agencies.

1. **SCOPE.** This commercial item description (CID) covers the general requirements for coupling assemblies and menders, hose. Coupling assemblies and menders, hose covered by this CID are intended for commercial/industrial applications.

1. **SCOPE.** This commercial item description (CID) covers the general requirements for coupling assemblies and menders, hose. Coupling assemblies and menders, hose covered by this CID are intended for commercial/industrial applications.

2. **CLASSIFICATION/PART OR IDENTIFICATION NUMBER (PIN).** This CID uses a classification system which is included in the PIN as shown in the following examples (see 7.1).

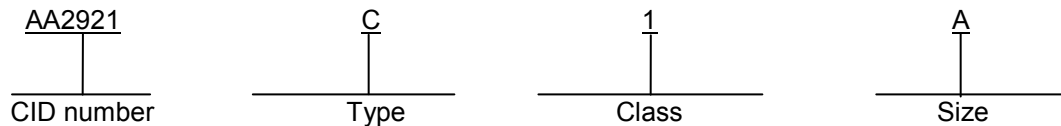

2.1 Types, classes and sizes. The coupling assemblies and menders shall be of the type, class and size as specified.

Type.

I	-	(Coupling)	Code C
II	-	(Mender)	Code M

Class.

1	-	Non-reusable	Code 1
2	-	Reusable	Code 2

Size.

A	-	5/8	Code A
B	-	3/4	Code B

Beneficial comments, recommendations, additions, deletions, clarifications, etc., and any data that may improve this document should be sent to: DLA Land and Maritime, ATTN: VAI, P.O. Box 3990, Columbus OH 43218-3990, or email fluidflow@dla.mil. Since contact information can change you may want to verify the currency of the address information using the ASSIST Online database at <https://assist.dla.mil>.

A-A-2921B

Examples of PIN construction:

AA2921C2B. This would be for a reusable coupling for a 3/4-inch hose.

AA2921C1A. This would be for a non-reusable coupling for a 5/8-inch hose.

AA2921M1A. This would be for a non-reusable mender for a 5/8-inch hose.

AA2921M2B. This would be for a reusable mender for a 3/4-inch hose.

3. SALIENT CHARACTERISTICS.

3.1 Interface and physical dimensions. Coupling assemblies and menders hose supplied to this CID shall be as specified herein (see figure 1).

3.1.1 Manufacturer's standard commercial product. Except otherwise specified herein, the coupling assemblies and menders covered by this CID shall be the manufacturer's standard commercial product. Materials not specifically specified shall be the quality used in commercial practice. Coupling assemblies and menders furnished under this CID shall meet the requirements as specified in this CID. Characteristics, materials and sizes to be used as follows:

3.1.2 Coupling assemblies: Used to replace damaged male and female fittings used on 5/8 and 3/4-inch garden hoses.

3.1.3 Repair sizes: Used to repair 5/8 and 3/4-inch damaged or cut hoses, or to attach an additional length of hose without using the male or female fittings used on the coupling assemblies

3.2. Design and construction. Coupling assemblies and menders, hose are intended for use with plastic or rubber garden hose

3.2.1 Coupling assemblies: Each coupling assembly shall be furnished with a male and female end. The male end of the coupling assembly shall be capable of being joined to the swivel end of the female connection by a minimum of one full thread length.

3.2.2 Class 1: The coupling assemblies and menders shall have external zinc plated steel grippers capable of being attached to a hose without special tools. Each tube insert shall have a minimum of two cylindrical corrugations, with one corrugation engaged by the gripping device.

3.2.3 Class 2: The coupling assemblies and menders shall be capable of being attached to a hose by means of an internal or external threaded device at the manufacturer's option. If a special tool is required to engage the threads, the tool shall be furnished with each coupling assembly or mender. Menders without threaded devices shall have tube inserts with a minimum of three cylindrical corrugations.

3.3. Sizes: The sizes specified are the inside diameter of the hose the coupling assemblies and menders are to be used with.

3.4. Threads: Mating threads and threaded devices for the coupling assemblies and menders shall be the NH series in accordance with ASME B1.20.7.

3.5. Washer: A rubber washer shall be furnished as a component part of each coupling assembly.

3.6 Marking. Coupling assemblies and menders hose supplied to this CID shall be marked with the manufacturer's (MFR's) standard commercial PIN. (NOTE: The part number marked on the unit pack shall be the CID PIN.)

A-A-2921B

3.7 Recycled, recovered, or environmentally preferable materials. Recycled, recovered, or environmentally preferable materials should be used to the maximum extent possible provided that the material meets or exceeds the operational and maintenance requirements, and promotes economically advantageous life cycle costs.

3.8 Workmanship. Coupling assemblies and menders hose shall be processed in such a manner as to be uniform in quality and shall be free from other defects that will affect life, serviceability, or appearance.

4. REGULATORY REQUIREMENTS. The offeror/contractor is encouraged to use recovered materials to the maximum extent practicable, in accordance with 23.403 of the Federal Acquisition Regulation (FAR).

5. PRODUCT CONFORMANCE PROVISIONS.

5.1 Product conformance. The products provided shall meet the salient characteristics of this CID, conform to the producer's own drawings, specifications, standards, and quality assurance practices, and be the same product offered for sale in the commercial market. The Government reserves the right to require proof of such conformance

5.2 Certification. Certification may be done as an option to testing by using the government's trusted suppliers and by with the procuring activity approval. The contractor shall certify that the product offered meets the requirements of this document and manufactured to industry standards, and quality assurance practices, and is the same as the product offered for sale in the commercial marketplace. The government reserves the right to require proof of such conformance prior to first delivery and thereafter as may be otherwise provided for under the provisions of the contract

6. PACKAGING. Preservation, packing, and marking shall be as specified in the contract or order.

7. NOTES.

7.1 PIN. The PIN should be used for Government purposes to buy commercial products to this CID. See section 2 for PIN format examples.

7.2 Environmentally preferable material. Environmentally preferable materials should be used to the maximum extent possible to meet the requirements of this specification. As of the dating of this document, the U.S. Environmental Protection Agency (EPA) is focusing efforts on reducing 31 priority chemicals. The list of chemicals and additional information is available on their website <http://www.epa.gov/osw/hazard/wastemin/priority.htm>. Included in the EPA list of 31 priority chemicals are cadmium, lead, and mercury. Use of these materials should be minimized or eliminated unless needed to meet the requirements specified herein (see Section 3).

7.3 Commercial and Government Entity (CAGE) code. For ordering purposes, inventory control, and submission of these coupling assemblies and menders, hose to DLA Land and Maritime under the Parts Management Advisory Team (PMAT) program CAGE code 58536 should be used.

A-A-2921B

7.4 Source of documents.

FEDERAL REGULATIONS

FAR – Federal Acquisition Regulations (FAR)

(Copies of these documents are available online at www.acquisition.gov/comp/far/index.html or from the U.S. Government Printing Office, 732 North Capital Street, NW, Washington D.C. 20401.)

Other Publications

ASME INTERNATIONAL

ASME B1.20.7 - Hose Coupling Screw Threads (Inch)

(Copies of these documents are available online at <http://www.asme.org> or from the ASME International, Three Park Avenue, New York, NY 10016-5990).

7.5 Ordering data. The contract or order should specify the following:

- a. CID document number, revision, and CID PIN.
- b. Product conformance provisions or certification.
- c. Packaging requirements.

7.6 Commercial products. As part of the market analysis and research effort, this CID was coordinated with the following manufacturers of commercial products. At the time of CID preparation and coordination, these manufacturers were known to have commercial products that would meet the requirements of this CID. (NOTE: This information should not be considered as a list of approved manufacturers or be used to restrict acquisition to only the manufacturers shown.)

<u>MFR's /suppliers CAGE</u>	<u>MFG's/supplier's name and address</u>
61125	J.G.B. Enterprises Inc 115 Metropolitan Dr PO BOX 209 Liverpool, NY 13088-5389 Tel: (315) 451-2770 msalanger@jgbhose.com
5AJL3	Century Supply & Hose 7663 B Clinton HWY Powell, TN 37849-4110 Jeanette HARMON Tel: (865) 947-7911 jeane@centurysupplytn.com

A-A-2921B

4VU52

MATKOR Inc.
6524 Las Flores Dr
Boca Raton, FL 33433-2365
Mati Korman
Tel: (561) 483-9240
mati@matkor.com

74293

US Rubber Tech Inc
371 Shaw Rd
South San Francisco, CA 94080-6607
James J Janakes
usrt@aol.com
Tel: (650) 952-8991

7.7 Legacy. This commercial item description is a replacement for WW-C-1692 for all federal agencies (WW-C-1692 is canceled as of 12-July-1995 and copies of these documents are available online at <http://quicksearch.dla.mil> or from the U.S. Government Printing Office, 732 North Capital Street, NW, Washington D.C. 20401.)

7.8 Government users. To acquire information on obtaining these coupling assemblies and menders, hose from the Government inventory system, contact DLA Land and Maritime, ATTN DLA Land and Maritime Call Center (-NAB), P.O. Box 3990, Columbus, OH 43218-3990 or telephone (614) 692-2271 or (614) 692-3191.

7.9 Changes from previous issues. Marginal notations are not used in this revision to identify changes with respect to the previous issue due to the extensiveness of the changes

A-A-2921B

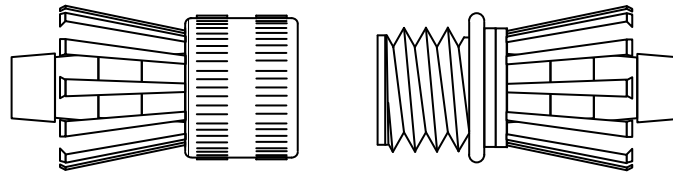

Coupling Assembly, Non-Reusable: Type 1, Class 1, Size A or B
(Illustration not to scale)

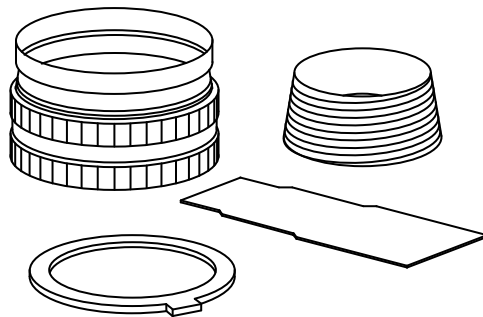

Coupling Assembly, Reusable
Type 1, Class 2, Size A
(Illustration not to scale)

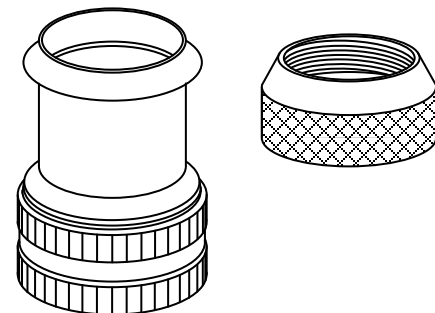

Coupling Assembly, Reusable
Type 1, Class 2, Size B
(Illustration not to scale)

FIGURE 1. Physical Configuration.

A-A-2921B

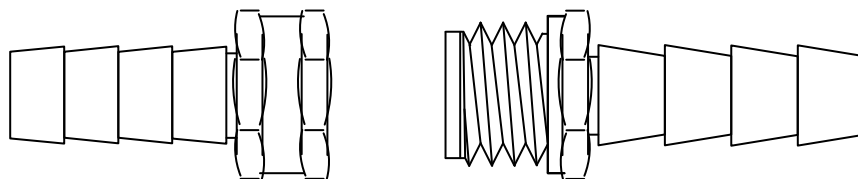

Coupling Assembly, Reusable: Type 1, Class 2, Size A or B
(Illustration not to scale)

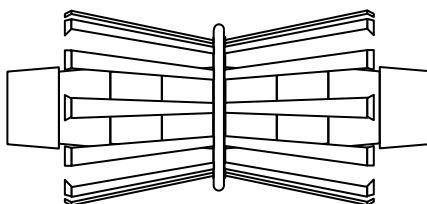

Mender, Non-reusable: Type 2, Class 1, Size A or B
(Illustration not to scale)

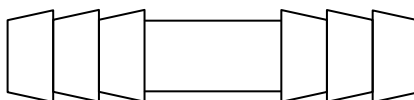

Mender, Reusable: Type 2, Class 2, Size A or B
(Illustration not to scale)

Note: These illustrations are not intended to preclude the purchase of couplings and menders of similar design, which are otherwise in accordance with the requirements of this CID.

FIGURE 1. Physical configuration - Continued.

A-A-2921B

MILITARY INTERESTS:

Custodians:
Air Force - 99
DLA - CC

CIVIL AGENCY COORDINATING ACTIVITY:

GSA – FSS

Preparing activity:
DLA - CC

Review activity:
Air Force - 71

Project 4730-2013-014

NOTE: The activities listed above were interested in this document as of the date of this document. Since organizations and responsibilities can change, you should verify the currency of the information above using the ASSIST Online database at <https://assist.dla.mil>.