

**AN122776  
THRU  
AN122802**

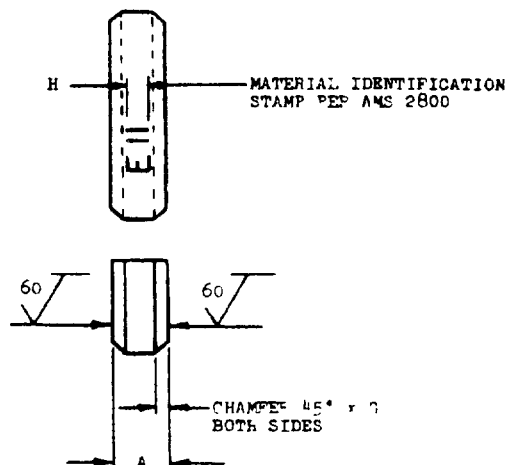
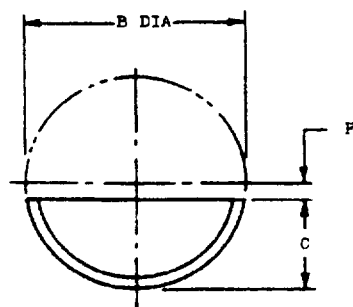

NOMINAL KEY SIZE (A x B)	A + .001C - .0000	B + .000 - .010	C + .000 - .005	F NOM	G (a)	H	PART NO
.062 x .500	.0625	.500	.203	.047	.010	.040± .020	AN122776
.094 x .500	.0938	.500	.203	.047	.020	.060± .020	AN122777
.094 x .625	.0938	.625	.250	.062	.020	.060± .020	AN122778
.125 x .500	.1250	.500	.203	.047	.030	.080± .020	AN122779
.125 x .625	.1250	.625	.250	.062	.030	.080± .020	AN122780
.125 x .750	.1250	.750	.313	.062	.030	.080± .020	AN122781
.156 x .625	.1563	.625	.250	.062	.030	.080± .020	AN122782
.156 x .750	.1563	.750	.313	.062	.030	.080± .020	AN122783
.156 x .875	.1563	.875	.375	.062	.040	.080± .020	AN122784
.188 x .750	.1875	.750	.313	.062	.040	.120± .030	AN122785
.188 x .875	.1875	.875	.375	.062	.040	.120± .030	AN122786
.188 x 1.000	.1875	1.000	.438	.062	.040	.120± .030	AN122787
.188 x 1.125	.1875	1.125	.484	.078	.040	.120± .030	AN122788
.250 x .875	.2500	.875	.375	.062	.050	.120± .030	AN122789
.250 x 1.000	.2500	1.000	.438	.062	.050	.120± .030	AN122790
.250 x 1.125	.2500	1.125	.484	.078	.050	.120± .030	AN122791
.250 x 1.250	.2500	1.250	.547	.078	.050	.120± .030	AN122792
.250 x 1.375	.2500	1.375	.594	.094	.050	.120± .030	AN122793
.250 x 1.500	.2500	1.500	.641	.109	.050	.120± .030	AN122794
.312 x 1.000	.3125	1.000	.438	.062	.050	.120± .030	AN122795
.312 x 1.125	.3125	1.125	.484	.078	.050	.120± .030	AN122796
.312 x 1.250	.3125	1.250	.547	.078	.050	.120± .030	AN122797
.312 x 1.375	.3125	1.375	.594	.094	.050	.120± .030	AN122798
.312 x 1.500	.3125	1.500	.641	.109	.050	.120± .030	AN122799
.375 x 1.250	.3750	1.250	.547	.078	.060	.120± .030	AN122800
.375 x 1.375	.3750	1.375	.594	.094	.060	.120± .030	AN122801
.375 x 1.500	.3750	1.500	.641	.109	.060	.120± .030	AN122802

(a) NOTE G TOLERANCE, +.010 -.000 WHEN G = .040 OR LESS  
+.015 -.000 WHEN G = .050 OR MORE

MATERIAL STEEL AMS 6322

HARDNESS ROCKWELL C40-45 HARDEN (OIL QUENCH) AND TEMPER

SURFACE ROUGHNESS AS107

REMOVE ALL BURRS. BREAK SHARP EDGES .003-.015

PARTS SUBJECT TO MAGNETIC INSPECTION PER AMS 2640

DIMENSIONS IN INCHES. UNLESS OTHERWISE SPECIFIED TOLERANCES,

LINEAR DIMENSIONS ±.010, ANGULAR DIMENSIONS ±2°

THIS STANDARD WAS DEVELOPED COOPERATIVELY WITH THE ENGINE AND PROPELLER STANDARD PARTS COMMITTEE OF THE SAE

PROCUREMENT  
SPECIFICATION

**AIR FORCE-NAVY AERONAUTICAL STANDARD**

KEY - CHAMFERED WOODRUFF

**AN122776  
THRU  
AN122802**

APPROVED 18 Sep 48 REVISED

Not for use in any aircraft or other aircraft component unless specifically approved by the Department of Defense. This document is the property of the Department of Defense and is loaned to your organization for use only. It is not to be distributed outside your organization. It is to be kept in a secure place and not to be loaned to any other person or organization. It is to be kept in a secure place and not to be loaned to any other person or organization. It is to be kept in a secure place and not to be loaned to any other person or organization.

Not for use in any aircraft or other aircraft component unless specifically approved by the Department of Defense. This document is the property of the Department of Defense and is loaned to your organization for use only. It is not to be distributed outside your organization. It is to be kept in a secure place and not to be loaned to any other person or organization. It is to be kept in a secure place and not to be loaned to any other person or organization. It is to be kept in a secure place and not to be loaned to any other person or organization.