

INCH-POUND

AN742 REV 13
 5 January 2011
 SUPERSEDING
 AN742 REV 12
 13 April 1995

DETAIL SPECIFICATION SHEET

CLAMP, LOOP, PLAIN, SUPPORT, AIRCRAFT

Inactive for new design after 13 April 1995.

This specification sheet is approved for use by all Departments and Agencies of the Department of Defense.

The requirements for acquiring the product described herein shall consist of this specification sheet and procurement specification MIL-C-8603.

SHAPE IN SOLID LINES REPRESENTS
 CLAMP AFTER SPRING BACK FROM
 THE 270 DEGREES FORMED POSITION

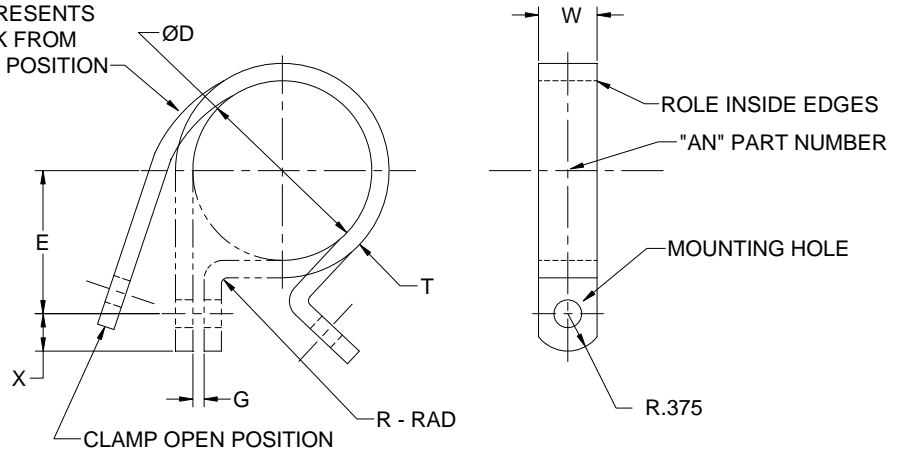

FIGURE I. Clamp.

AN742 REV 13

TABLE I. Part numbers and dimensions.

| DASH NUMBER | RIGID TUBE NOMINAL O.D. (REF) | ØD ±.010 | E | | G | R ±.010 | T | | | AL ALLOY | | ALL STEEL | | X |
|-------------|-------------------------------|----------|----------------|-----------|------------------------|---------|-----------------|--------------|----------------|----------|--------------------|-----------|--------------------|---|
| | | | ALUMINUM ALLOY | ALL STEEL | | | AL ALLOY | CARBON STEEL | HIGH TEMP CRES | W | MTG HOLE DIA ±.005 | W | MTG HOLE DIA ±.005 | |
| AN742-2 | .125 | .125 | .360 | .360 | .062 +.016 -.000 | 062 | .0320 ±.0025 | | .020 ±.003 | | | | | |
| AN742-3 | .188 | .188 | .423 | .423 | | | | | | | | | | |
| AN742-4 | .250 | .250 | .457 | .457 | | | | | | | | | | |
| AN742-5 | .313 | .313 | .498 | .498 | | | | | | | | | | |
| AN742-6 | .375 | .375 | .529 | .529 | | | | | | | | | | |
| AN742-7 | .438 | .438 | .560 | .560 | | | | | | | | | | |
| AN742-8 | .500 | .500 | .592 | .592 | | | | | | | | | | |
| AN742-9 | .563 | .563 | .623 | .623 | | | | | | | | | | |
| AN742-10 | .625 | .625 | .654 | .654 | | | | | | | | | | |
| AN742-11 | .688 | .688 | .752 | .749 | | | | | | | | | | |
| AN742-12 | .750 | .750 | .783 | .780 | | | | | | | | | | |
| AN742-13 | .813 | .813 | .814 | .811 | | | | | | | | | | |
| AN742-14 | .875 | .875 | .845 | .842 | | | | | | | | | | |
| AN742-15 | .938 | .938 | .877 | .858 | | | | | | | | | | |
| AN742-16 | 1.000 | 1.000 | .908 | .889 | | | | | | | | | | |
| AN742-17 | 1.063 | 1.063 | .939 | .920 | | | | | | | | | | |
| AN742-18 | 1.125 | 1.125 | .970 | .951 | | | | | | | | | | |
| AN742-19 | 1.188 | 1.188 | 1.002 | .983 | | | | | | | | | | |
| AN742-20 | 1.250 | 1.250 | 1.062 | 1.030 | | | | | | | | | | |
| AN742-21 | 1.313 | 1.313 | 1.093 | 1.061 | | | | | | | | | | |
| AN742-22 | 1.375 | 1.375 | 1.124 | 1.092 | | | | | | | | | | |
| AN742-23 | 1.438 | 1.438 | 1.156 | 1.124 | | | | | | | | | | |
| AN742-24 | 1.500 | 1.500 | 1.187 | 1.155 | | | | | | | | | | |
| AN742-25 | 1.563 | 1.563 | 1.218 | 1.186 | | | | | | | | | | |
| AN742-26 | 1.625 | 1.625 | 1.249 | 1.217 | | | | | | | | | | |
| AN742-27 | 1.688 | 1.688 | 1.281 | 1.249 | | | | | | | | | | |
| AN742-28 | 1.750 | 1.750 | 1.312 | 1.280 | | | | | | | | | | |
| AN742-29 | 1.812 | 1.812 | 1.344 | 1.312 | | | | | | | | | | |
| AN742-30 | 1.875 | 1.875 | 1.374 | 1.342 | | | | | | | | | | |
| AN742-31 | 1.938 | 1.938 | 1.406 | 1.374 | | | | | | | | | | |
| AN742-32 | 2.000 | 2.000 | 1.437 | 1.405 | | | | | | | | | | |
| AN742-33 | 2.062 | 2.062 | 1.468 | 1.444 | | | | | | | | | | |
| AN742-34 | 2.125 | 2.125 | 1.499 | 1.475 | | | | | | | | | | |
| AN742-35 | 2.188 | 2.188 | 1.531 | 1.507 | | | | | | | | | | |
| AN742-36 | 2.250 | 2.250 | 1.562 | 1.538 | | | | | | | | | | |
| AN742-37 | 2.312 | 2.312 | 1.594 | 1.570 | | | | | | | | | | |
| AN742-38 | 2.375 | 2.375 | 1.624 | 1.600 | | | | | | | | | | |
| AN742-40 | 2.500 | 2.500 | 1.687 | 1.663 | | | | | | | | | | |
| AN742-42 | 2.625 | 2.625 | 1.752 | 1.728 | | | | | | | | | | |
| AN742-43 | 2.680 | 2.680 | 1.778 | 1.754 | | | | | | | | | | |
| AN742-44 | 2.750 | 2.750 | 1.812 | 1.788 | | | | | | | | | | |
| AN742-45 | 2.812 | 2.812 | 1.844 | 1.820 | | | | | | | | | | |
| AN742-46 | 2.875 | 2.875 | 1.875 | 1.851 | | | | | | | | | | |
| AN742-48 | 3.000 | 3.000 | 1.937 | 1.913 | | | | | | | | | | |
| AN742-50 | 3.125 | 3.125 | 2.000 | 1.976 | | | | | | | | | | |
| AN742-52 | 3.250 | 3.250 | 2.062 | 2.038 | | | | | | | | | | |
| AN742-54 | 3.375 | 3.375 | 2.125 | 2.101 | | | | | | | | | | |
| AN742-56 | 3.500 | 3.500 | 2.187 | 2.163 | | | | | | | | | | |
| AN742-58 | 3.625 | 3.625 | 2.250 | 2.226 | | | | | | | | | | |
| AN742-64 | 4.000 | 4.000 | 2.437 | 2.413 | | | | | | | | | | |
| AN742-66 | 4.125 | 4.125 | 2.500 | 2.476 | | | | | | | | | | |

AN742 REV 13

Requirements:

1. Materials and Finish:
 - (-) = AISI-1010 steel, temper T 4 per ASTM-A109/A109M.
Finish – Cadmium plated per SAE-AMS-QQ-P-416, Type II, Class 2.
 - (D) = ALCLAD 2024-0, Aluminum Alloy per SAE-AMS-QQ-A-250/5
Heat treated per SAE AMS2770 to T42 condition.
Finish – Chemical film per MIL-DTL-5541, Class 1A.
 - (F) = AISI-321 Corrosion Resistant Steel per SAE-AMS 5510.
Finish – Passivated per SAE-AMS-QQ-P-35.

Notes:

1. Example of part number:

AN742-8 = Clamp, Steel, .500 I.D.

AN742D8 = Clamp, Aluminum Alloy, .500 I.D.

AN742F8 = Clamp, Corrosion Resistant Steel, .500 I.D.

2. The part number and the Manufacturer's identification shall be marked on each clamp.
3. Remove all burrs and sharp edges.
4. Dimensions in inches. Unless otherwise specified, tolerances: $\pm .015$.
5. Clamps shall be furnished in the open position.
6. For design feature purposes, this standard takes precedence over the procurement document referenced herein. Referenced documents shall be of the issue in effect on the date of invitation for bid.
7. Code "F" clamp manufactured from SAE-AMS 5510 CRES shall be used in both corrosive and high temperature environment.
8. Code "H" clamp has been superseded by code "F" as of 30 December 1993, however code "H" clamp shall be used until existing stocks are depleted.
9. Code "-" clamp is inactive for new design as of 13 April 1995. Code "D" and code "F" clamps are cancelled after 31 January 2001 and superseded by code "D" and code "C" clamps per AS5587 (see Interchangeability Table). Code "D" and code "F" clamps shall be used until existing stocks are depleted.
10. Cancelled part number listed in the interchangeability table are cancelled after 31 January 2001. Replacement part number can replace cancelled part number universally but cancelled part number can not replace replacement part number universally.
11. Changes from previous issue. Marginal notations are not used in this revision to identify changes with respect to the previous issue due to the extent of the changes.

AN742 REV 13

Table II. Interchangeability Table.

| Cancelled AN part number | Replacement AS part number |
|--------------------------|----------------------------|
| AN742D() | AS5587D() |
| AN742F() or AN742H() | AS5587C() |

() Represents the same dash number for AN & AS part number (AS part number requires "0" be added to dash number for dash number that is less than 10).

Examples: AN742D8 AS5587D08
 AN742F4 AS5587C04
 AN742H11 AS5587C11

Custodians:

Army - AV
 Navy - AS
 Air Force - 99

Preparing Activity:

DLA -IS

(Project 5340-2011-001)

Review Activities:

Air Force - 71

NOTE: The activities listed above were interested in this document as of the date of this document. Since organizations and responsibilities can change, you should verify the currency of the information above using the ASSIST Online database at <https://assist.daps.dla.mil>.