

USER SYMBOLS:

REVIEWER SYMBOLS:
 NAVY-AS ARMY-2V
 USAF-11 DSA-15

"Review/user information is current as of the date of this document. For future coordination of changes to this document, draft circulation should be based on the information in the current DODDIS."

This military standard is approved for use by all Departments & Agencies of the Department of Defense. Selection for all new engineering and design applications and for repetitive use shall be made from this document.

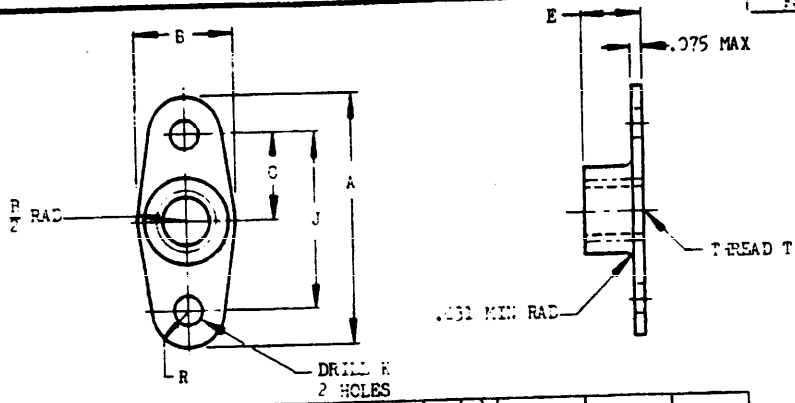

SIZE	A		B		C NOM	E MAX	J ±.002	K +.005 -.000 DIA	R MIN RAD
	MAX	MAX	MIN	MIN					
NO. 6			.250			.23L			
NO. 8	.985	.407	.282		.34L	.297	.688	.098	.100
NO. 10			.31L			.312			.115
1/4	1.297		.516	.37L	.500	.375	1.000	.130	.125
5/16			.532	.500		.453			
3/8			.641	.609					

DASH NUMBERS		THREAD T
STEEL	COR RES STEEL	
F670	C640	NO. 6-32NF-2B
F636	C636	NO. 8-32NF-2B
F1032	C1032	NO. 10-32NF-3B
F428	C428	1/4 - 28NF-3B
F524	C524	5/16 - 24NF-3B
F624	C624	3/8 - 24 NF - 3B

DASH NUMBERS		THREAD T
STEEL	COR RES STEEL	
F632	C632	NO. 6-32NC-2B
F632	C632	NO. 8-32NC-2B
F1024	C1024	NO. 10-24NC-2B
F428	C428	1/4 - 28UNC-3B
F516	C516	5/16 - 18UNC-3B
F616	C616	3/8 - 16 UNC - 3B

INACTIVE FOR NEW DESIGN AFTER 7 APRIL 1967 USE MS21047 OR MS21048

- (a) MINIMUM E NOT SPECIFIED. LIMITED ONLY BY STRENGTH REQUIREMENT OF SPECIFICATION.
 - (b) THE CENTER OF THE TAPPED HOLE SHALL NOT DEVIATE IN ANY DIRECTION FROM THE CENTER OF THE PLATE NUT AS DETERMINED BY THE RIVET HOLES BY MORE THAN .005.
 - (c) DASH NUMBERS F630, F636, C630, C636, F1024, F428, F516, F616, C1024, C428, C516, AND C616 INACTIVE FOR DESIGN AFTER 14 APRIL 1949.
- FOR DEFINITION AND APPLICATION OF DRAWING STATUS NOTE, SEE ANA BULLETIN NO. 337.
 SHAPE OF TOP OPTIONAL TO SUIT LOCKING METHOD.
 NUTS MAY BE MADE OF SHEET METAL.
 NUTS FOR USE BY WELDING TO BE MADE OF COR RES STEEL AND WITHOUT RIVET HOLES. SPACING OF WELDING PROJECTIONS MUST BE EQUAL TO DIMENSION J.
 ADD W BEFORE COR RES STEEL DASH NUMBERS FOR PLATE NUTS FOR USE BY WELDING.
 EXAMPLES OF PART NUMBERS: AN362F428 = 1/4-28 STEEL NUT.
 AN362C428 = 1/4-28 COR RES STEEL NUT.
 AN362W428 = 1/4-28 COR RES STEEL NUT FOR USE BY WELDING.

- ⑥ * QUALIFICATION NOT REQUIRED
- ⑥ DIMENSIONS IN INCHES, UNLESS OTHERWISE SPECIFIED, TOLERANCES: DECIMALS ±.016. FOR INSTALLATION INSTRUCTIONS SEE MS33500.
- ⑥ CANCELLED SEE SHEET 2

PROCUREMENT SPECIFICATION MIL-N-25027	AIR FORCE-NAVY AERONAUTICAL STANDARD NUT, SELF-LOCKING, PLATE, NON-COUNTERSUNK, 550°P	AN362 SHEET 1 OF 2 SUPERSEDES USAF DRAWING 362
--	---	---

APPROVED 13 Jul 45 REVISED ① 20 Nov 45 ② 14 Apr 49 ③ 10 May 56 ④ 17 Feb 59 ⑤ 7 Apr 67 ⑥ 25 May 72

USER SYMBOLS:

REVIEWER SYMBOLS:
 NAVY-AS
 USAF-11
 ARMY-AV
 DSA-1S

" Reviewer/user information is current as of the date of this document. For future coordination of changes to this document, draft circulation should be based on the information in the current DODISS"

This military standard is approved for use by all Departments & Agencies of the Department of Defense. Selection for all new engineering and design applications and for repetitive use shall be made from this document.

(6)
CANCELED IN PART AFTER 25 MAY 1972 DASH NUMBERS
F640, F836, C640, C836, F1024, F420, F518, F616,
C1024, C420, C518, AND C616 NOT CANCELED. FOR
SUBSTITUTIVE PARTS SEE INTERCHANGEABILITY TABLES
ON MS21047 AND MS21048.

U. S. GOVERNMENT PRINTING OFFICE: 1972-714-167/7796

APPROVED 13 JUL 65 REVISED (6) FOR CHANGES SEE SHEETS 1 AND 2.

PROCUREMENT SPECIFICATION *MIL-N-25027	AIR FORCE-NAVY AERONAUTICAL STANDARD	AN362
	NUT, SELF-LOCKING, PLATE, NON-COUNTERSUNK, 550°F	