

NOTE: This drawing was approved by joint action of the Air Force and Navy Departments and is the standard for this product. This drawing supersedes all antecedent standard drawings for this product and shall become effective for the procurement of aeronautical supplies, or for use in new facilities, not later than 9 months after the latest date of approval shown.

NOTE: When Government drawings, specifications, or other data are used for any purpose other than in connection with the procurement of supplies, the United States Government thereby incurs no responsibility, nor any obligation whatsoever, except as may be indicated by specific reference to such drawings, specifications, or other data in any contract or order for supplies or services.

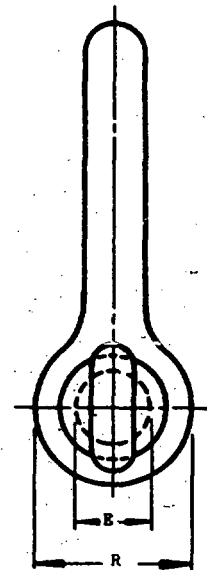
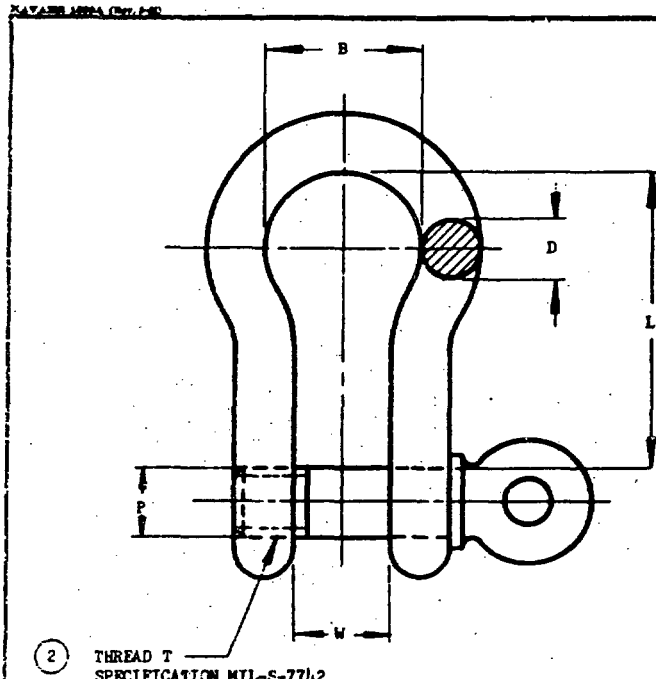

SECTION 116-1											
2											
2											
2											
2											
2											
2											
2											
2											
2											
2											
2											
2											
2											
2											
2											
2											
2											
2											
2											
2											
2											
2											
2											
2											
2											
2											
2											
2											
2											
2											
2											
2											
2											
2											
2											
2											
2											
2											
2											
2											
2											
2											
2											
2											
2											
2											
2											
2											
2											
2											
2											
2											
2											
2											
2											
2											
2											
2											
2											
2											
2											
2											
2											
2											
2											
2											
2											
2											
2											
2											
2											
2											
2											
2											
2											
2											
2											
2											
2											
2											
2											
2											
2											
2											
2											
2											
2											
2											
2											
2											
2											
2											
2											
2											
2											
2											
2											
2											
2											
2											
2											
2											
2											
2											
2											
2											
2											
2											
2											
2											
2											
2											
2											
2											
2											
2											
2											
2											
2											
2											
2											
2											
2											
2											
2											
2											
2											
2											
2											
2											
2											
2											
2											
2											
2											
2											
2											
2											
2											
2											
2											
2											
2											
2											
2											
2											
2											
2											
2											
2											
2											
2											
2											
2											
2											
2											
2											
2											
2											
2											
2											
2											
2											
2											
2											
2											
2											
2											
2											
2											
2											
2											
2											
2											
2											
2											
2											
2											
2											
2											
2											
2											
2											
2											
2											
2											
2											
2											
2											
2											
2											
2											
2											
2											
2											
2											
2											
2											
2											
2											
2											
2											
2											
2											
2											
2											
2											
2											
2											
2											
2											
2											
2											
2											
2											
2											
2											
2											
2											
2											
2											
2											
2											
2											
2											
2											
2											
2											
2											
2											
2											
2											
2											
2											
2											
2											
2											
2											
2											
2											
2											
2											
2											
2											
2											
2											
2											
2											
2											
2											
2											
2											
2											
2											
2											
2											
2											
2											
2											
2											
2											
2											
2											
2											
2											
2											
2											
2											
2											
2											
2											
2											
2											
2											
2											
2											
2											
2											
2											
2											
2											
2											
2											
2											
2											
2											
2											
2											
2											
2											
2											
2											
2											
2											
2											
2											
2											
2											
2											
2											
2											
2											
2											
2											
2											
2											
2											
2											
2											
2											
2											
2											
2											
2											
2											
2											
2											
2											
2											
2											
2											
2											
2											
2											
2											
2											
2											
2											
2											
2											
2											
2											
2											
2											
2											
2											
2											
2											
2											
2											
2											
2											
2											
2											
2											
2											
2											
2											
2											
2											
2											
2											
2											
2											
2											
2											
2											
2											
2											
2											
2											
2											
2											
2											
2											
2											
2											
2											
2											
2											
2											
2											
2											
2											
2											
2											
2											
2											
2											
2											
2											
2											
2											
2											
2											
2											
2											
2											
2											
2											
2											
2											
2											
2											
2											
2											
2											
2											
2											
2											
2											
2											
2											
2											
2											
2											
2											
2											
2											
2											
2											
2											
2											
2											
2											
2											
2											
2											
2											
2											
2											
2											
2											

(2) (a) AN PART NUMBERS AN116-7 AND AN116-9 INACTIVE FOR DESIGN AFTER 23 NOVEMBER 1956.

(2) FOR DEFINITION AND APPLICATION OF DRAWING STATUS NOTES, SEE AIA BULLETIN NO. 337.

(2) MATERIAL: GRADE C FORGED CARBON STEEL, SEE PROCUREMENT SPECIFICATION.

(2) FINISH: ZINC COATING, SEE PROCUREMENT SPECIFICATION, EXCEPT IF THE HOT-DIP (GALVANIZING) PROCESS IS USED, THE COATING SHALL BE APPLIED IN ACCORDANCE WITH SPECIFICATION ASTM A-153.

DIMENSIONS IN INCHES.

(2) MAXIMUM WORKING LOAD EQUAL TO 1/5 MINIMUM BREAKING STRENGTH.

PROCUREMENT SPECIFICATION

RR-C-271
TYPE IV, CLASS 1

AIR FORCE-NAVY AERONAUTICAL STANDARD

(2) SHACKLE, ANCHOR, FORGED CARBON STEEL SCREW PIN

AN116

APPROVED 8 Jun 51 2 20 Nov 56